



# NJ-85A01

Soft Close

130 pound class (60 kgs)

## Product Photo



## Features



**Mounting** | Side mount.  
**Side Clearance** | 12.7mm plus 0.76 mm, minus 0 each side.

**Height** | 54.5 mm  
**Loading** | 130 pound class (60 kgs)  
**Size** | 350 mm to 600 mm at 50 mm increment

**Feature** | Brand new dampening design, no hassle of grease leaking or drawer bounce. 50 mm self close stroke, extremely light and silent movement, heavy duty loading with less deflection.

**Option** | None.

**\*SCREW HEAD MUST BE completely flush or under the slide member.**

## Profile

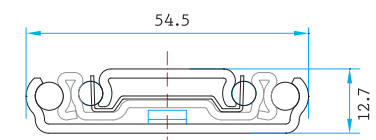

## Surface Treatment

- Clear Zinc
- Black Zinc
- Black E. Coating
- White E Coating
- Stainless Steel
- Galvanized Steel

## Packaging

- Distribution / 10 pairs per box

\*Box QTY might vary with different length, the info provided here is based on 18" (450 mm)

## Drawing

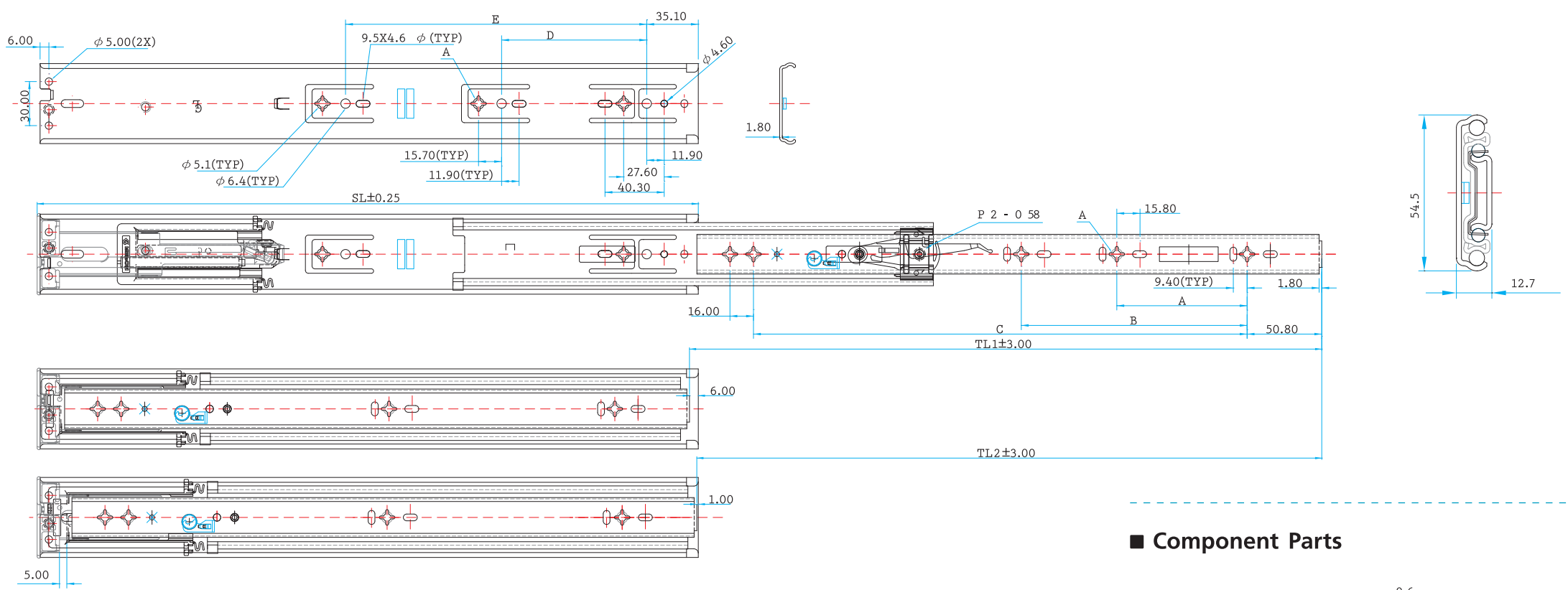

## Profile

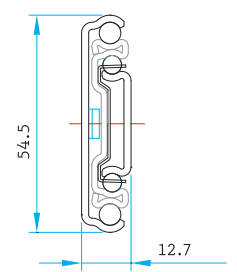

## Component Parts

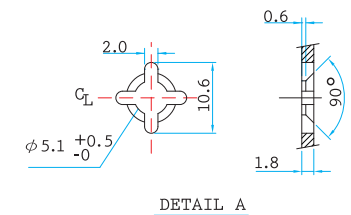

## Specification Table

SIZE	SL	TL1	TL2	A	B	C	D	E
12" (300mm)	300.00	209.81	204.81			192.00		
14" (350mm)	350.00	284.40	279.40			240.00		
16" (400mm)	400.00	357.00	352.00	96.00		288.00	128.00	
18" (450mm)	450.00	430.41	425.41	160.00		336.00	160.00	
20" (500mm)	500.00	505.00	500.00	96.00	192.00	384.00	128.00	224.00
22" (550mm)	550.00	555.00	550.00	128.00	224.00	448.00	128.00	256.00
24" (600mm)	600.00	605.00	600.00	160.00	256.00	480.00	160.00	320.00
26" (650mm)	650.00	655.00	650.00	256.00	448.00	528.00	160.00	384.00

## Installation Instructions

### QUICK INSTALLATION GUIDE OF NJ-85A01

Soft Close, 130 pound (60 kgs) loading

**READ ALL INSTRUCTIONS THOROUGHLY BEFORE BEGINNING INSTALLATION**

A. Each slide requires a minimum of 6 screws, included. Counter sink or flat head screws are recommended.

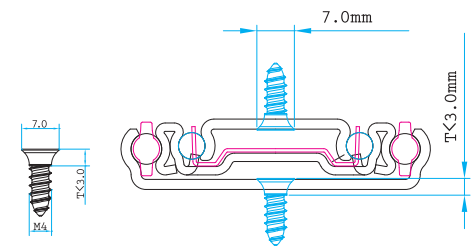

### Technical Specifications for drawer or pull-out shelf

- Drawer or pulling-out shelf must be at least 13.0 mm narrower than cabinet opening on each side (DIM A)
- Bottom of drawer or pulling-out shelf bottom shall have 6.4 mm or 1/4" minimum clearance from the bottom of Cabinet (DIM B)
- Mark a center line with proper height (H) from the bottom of cabinet (DIM C)
- Mark a center line with proper height (H-6.4 mm) from the bottom of drawer (DIM D)

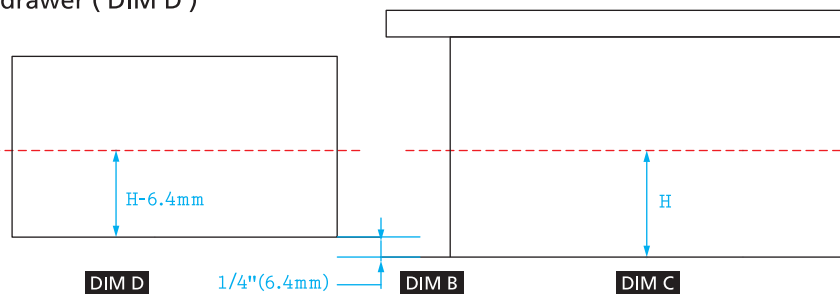

### Step 1 > Install cabinet member to cabinet

**\*Note-** For proper performance, ensure slides are mounted parallel to each other vertically and horizontally.

To separate the drawer member from the cabinet member, push down/lift up the release trigger and then pull the unit all the way out until it's disconnected. (Figure1-1)

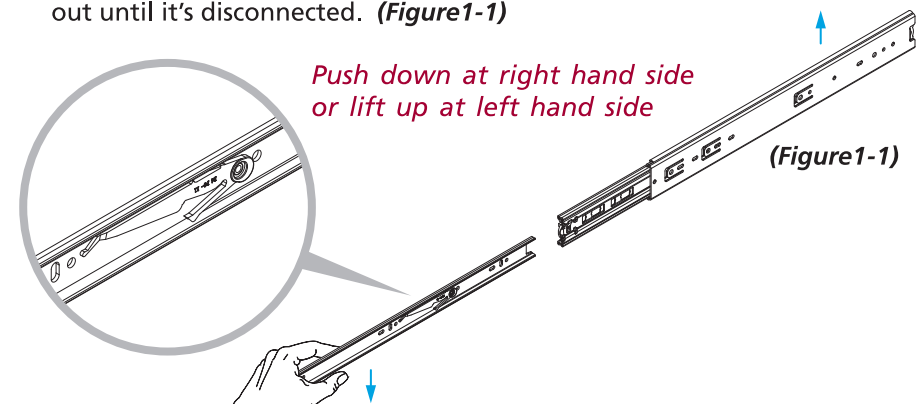

Align center of cabinet member to pre-determined C/L (H\*) and place the slide 2 mm back from the front edge of the cabinet. (Figure1-2)

Use hole on breather tab for side adjustment

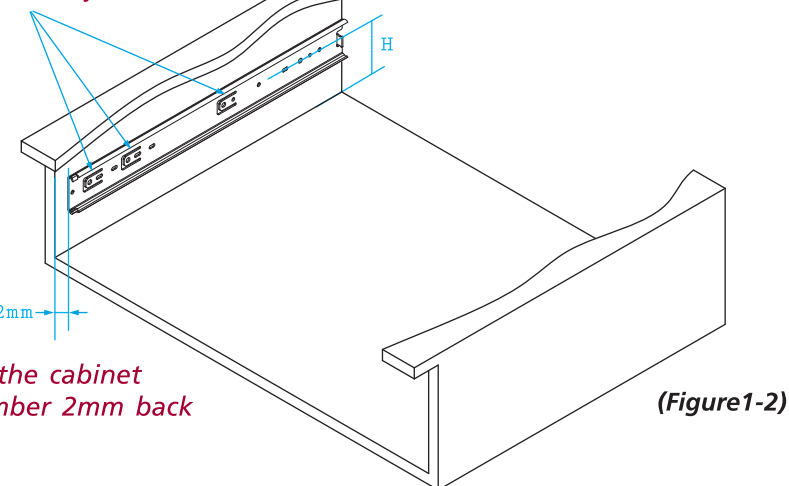

Set the cabinet member 2mm back

Fix the cabinet member through the star shaped holes for best performance. Leave the screws loose for final adjustment.

### Step 2 > Install drawer member to drawer

Align center of drawer member to pre-determined center line (H-6.4 mm) and place drawer member 2 mm back from the front edge of the drawer or the pulling out edge of the shelf. If a bumper is to be used (\*Note - not provided by Repon), place the drawer member 2 mm + the thickness of the bumper from the front edge of the drawer. (Figure2-1)

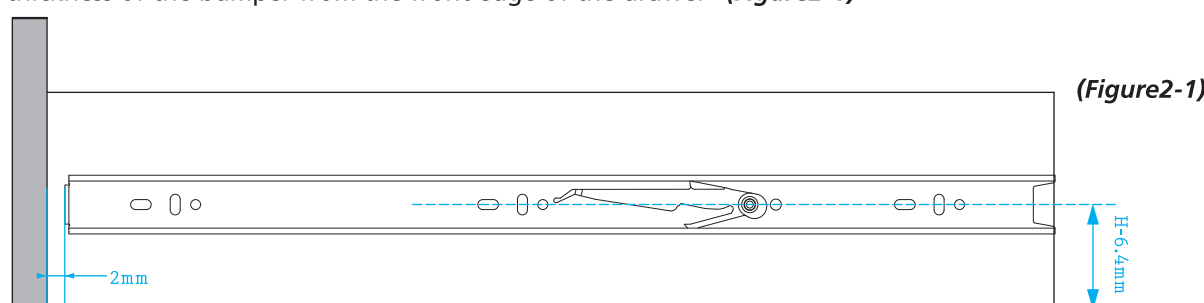

### VERY IMPORTANT!!

Screws MUST be flushed under the drawer member through the star shaped holes or else it may cause self close to malfunction. Leave the screws loose for final adjustment.

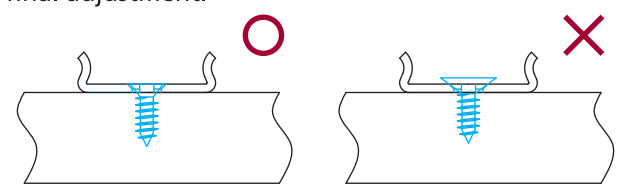

### Step 3 > Insert drawer into cabinet

Make sure the bearing retainers are set to the front of the slides. Insert drawer member into cabinet member and then push the drawer all the way in. Never use force when inserting the drawer. (Figure3-1)

\*Note-If the drawer could not be closed, repeat Step 1 and then Step 3 to reinsert the drawer into the cabinet.

Make sure retainer is fully forward

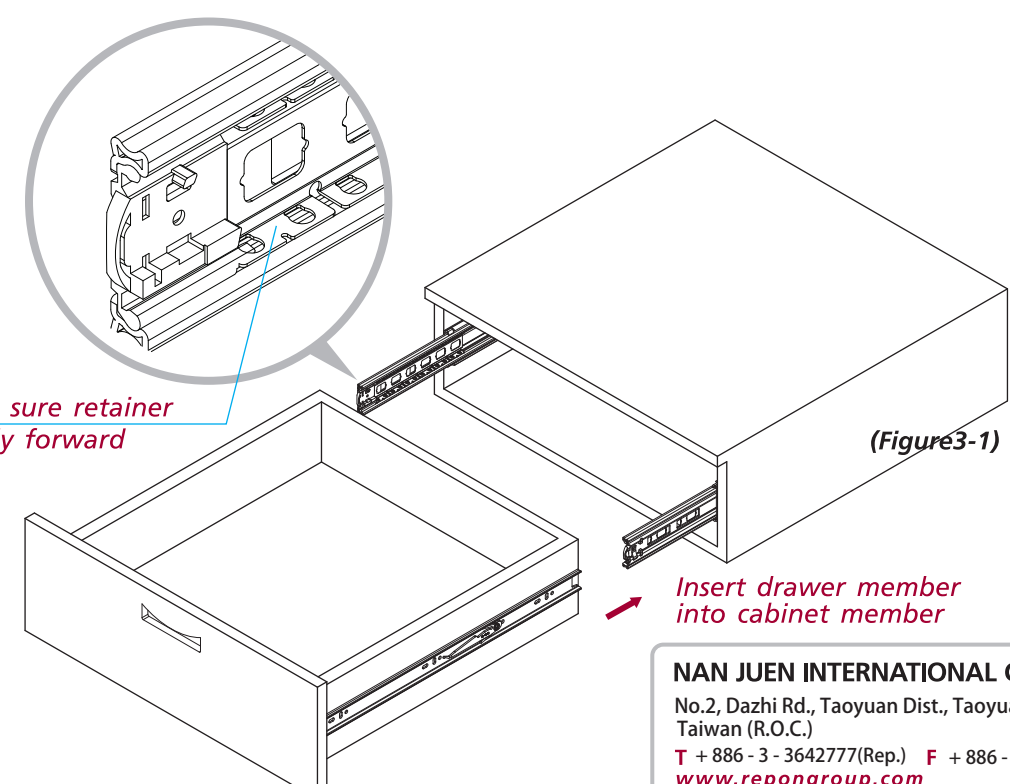

### Final Adjustment / installation

Try to open and close the drawer to see if the slides function correctly and make sure no screws are interfering during opening and closing of the drawer. Drawers should move smoothly without any binding. There may be some resistance during the first time when balls in the retainer are being synchronized.

If the drawer functions correctly, secure the screws and install additional screws if necessary. If not, make necessary adjustments until the slides function correctly.