



*Slides into Your Life!*

## REPON Total Solution

---



### Kitchen Island Top Series

NJ-KA001 360° Pivot

NJ-KB001 Sliding Countertop

NJ-KB002 Concealed Top

## Undermount Slide

---



### Undermount Wood

NJ-A5K01

NJ-A5K03

V-Line

## Slidemount Slide

---



### Soft Close

NJ-35D65

NJ-85A01

NJ-78036



### Push Open

NJ-38D58

NJ-78A01



### Lock In & Out

NJ-76J05



### Two Way

NJ-76Q01



### Loading

NJ-31J32

NJ-76008

NJ-81A02

NJ-76J01





# THE NAME OF BALL-BEARING SLIDES

Repon has been in business for over 45 years, started as a computer case manufacturer, moved on to customized drawer slides business, and now we are specialized in industrial and cloud computing slides. Our goal has never been compromised, which is pursuing the ultimate customer satisfaction.

We comprise 3 large scale production plants with highly vertical integration from product design, manufacturing, packaging all the way to marketing. Our service covers a variety of industries including

**Office furniture, Kitchen, Tool box,  
Residential area, Appliance,  
Medical cart, RV,  
industrial applications  
and servers ...**

With Repon's complete product line and powerful RD capability, we are committed to continuous improvement on our service and technology for a brighter future along with our partners.

It is more than a ball bearing slide, it is a life time commitment to Repon.

*Slides **into** your Life!*

2011

2014



Shallow Drawer Frame

2013



SB Tool-Less



Wooden Drawer





## TAIWAN EXCELLENCE



# PROFILE

NJ-3J ( 100lb / 45Kgs )

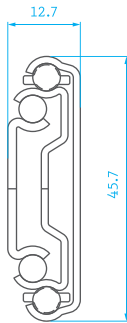

NJ-3D ( 100lb / 45Kgs )

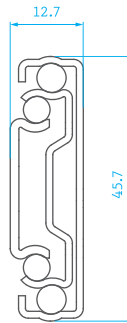

NJ-7000 ( 200lb / 90Kgs )

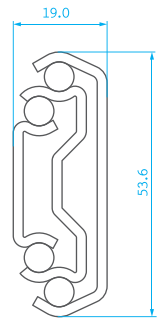

NJ-7A ( 180lb / 80Kgs )

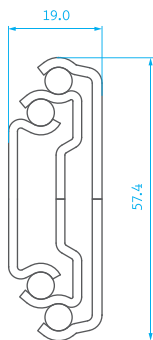

NJ-7J ( 400lbs / 180Kgs )

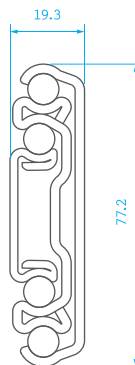

NJ-7Q ( 300lb / 140Kgs )

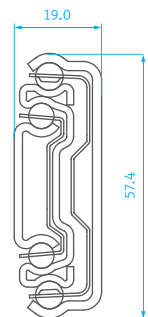

NJ-8A ( 130lb / 60Kgs )

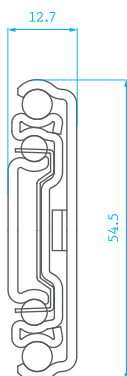

NJ-A5K01 / 02 ( 75lb / 35Kgs )

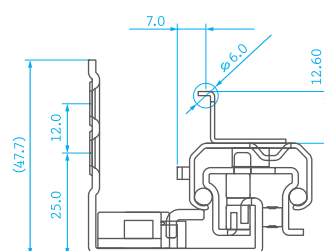

NJ-A5K03 ( 75lb / 35Kgs )

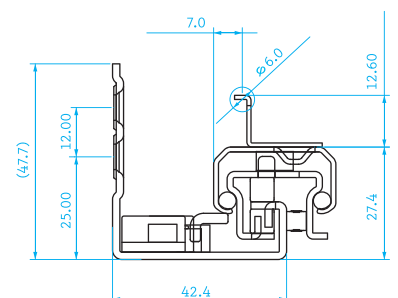



## How you select the slide fitting your needs.

---

- ☒ Step 1. Determine the slide length and extension.
- ☒ Step 2. Find out which capacity your application might require.
- ☒ Step 3. Select the appropriate function feature to couple with your application.
- ☒ Step 4. Match your ideal solution with your budget.
- ☒ Step 5. Please contact Repon.

**We will present the best possible solution and suggestion for installation to you.**



DM Download

TOTAL

Hang



REPON

360°

Drawer  
Table

Sliding

Germany

# SOLUTION

**RTS is short for REPON Total Solution**

We create a product line for high end woodworking accessories with our age long expertise and partnership.

We wish to provide customer with a much better service and product with high added value.

## 360° Pivot Extravagant-Flexible

### Highly Flexible,

Luxury and Versatile island top pivot  
Island top width 1400mm, 1200mm.  
Loading 60kgs.

Top is extendible, rotatable and hold  
in any position with perpendicular  
safety locking.





# Sliding Countertop

Linear top function as space transformer with will become its synchorized slide motion.

With an easy push or pull, the island top will become a dining table where you serve your family or friend, and transform your kitchen into a social space.

The linear top mechanism is totally concealed, which provides a neat and clean facade to kitchen island.

Dynamic loading 150kgs Static loading 300kgs.



## Concealed Top

The side top is retractable into the side of kithcen island.

With an easy push or pull, you may transform your space between residential and social space.

The leg-less design carries 80kgs for 10,000 cycles, and it runs in a smooth and silent fashion.





# Drawer Table

## The Hidden Table

LGA-certified for loads of 90kg  
Converted cupboards to a table till to 900mm with  
patented hinge system for unfolding the front panel.

Designed with telescopic slide mand  
of vibration-damping aluminium  
profile.

Equipped with a patented, automatic  
locking and unlocking mechanism.

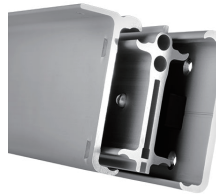





## NJ - A5K01

### Undermound System

4 way adjustment quick removal handles, incorporating dry damper designed for 16 mm, metric measurement.



## NJ - A5K03

### Undermound System

2 way adjustment quick removal handles, incorporating dry damper designed for 18 mm, metric measurement.

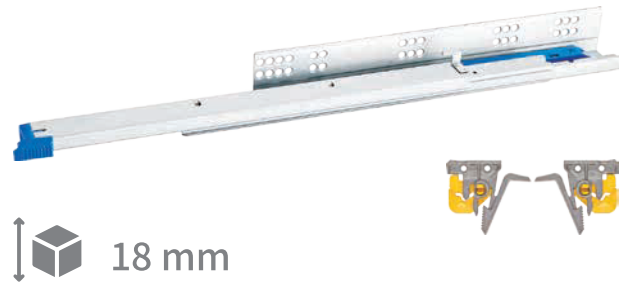

## Slim Drawer System

### V-Line

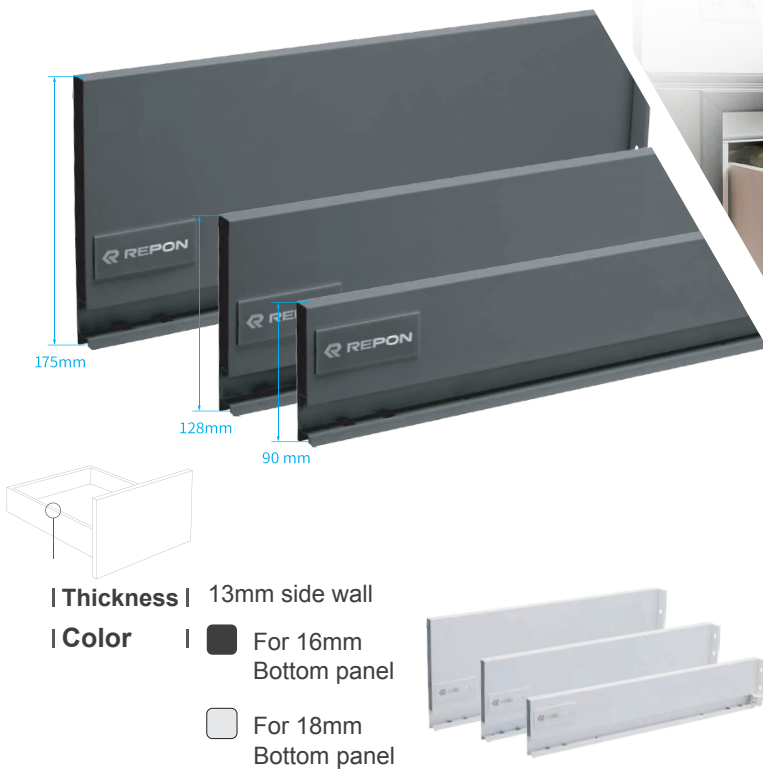

## Wooden Drawer System

### Wooden Drawer



<b>Function</b>	<input type="checkbox"/> Soft Close	<input type="checkbox"/> Soft Close & Push to Open
<b>Construction</b>	<input type="checkbox"/> Frameless	<input type="checkbox"/> Faceframe
<b>Drawer Side</b>	<input type="checkbox"/> 16mm ( $\frac{5}{8}$ inch)	<input type="checkbox"/> 18mm ( $\frac{3}{4}$ inch)
<b>Adjustment</b>	<input type="checkbox"/> 1D	<input type="checkbox"/> 2D <input type="checkbox"/> 3D





# A5K

**NEW** UNDERMOUNT  
CONCEALED SLIDES!



New version  
provides a better movement,  
enhanced deflection performance  
and seamlessly soft closing.





## SAFE

Drawer anti lifting  
Preventing accidental drawer  
lift by unique quick removal  
handle lock design.

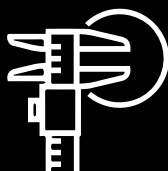

## PRECISE

Height and side four way  
adjustment  
Adjusting drawer panel  
clearance easily with precise  
handle design.



## STRONG

1.2 mm thickness of drawer member.  
Slight deflection with stronger  
drawer support strength.

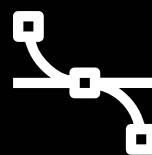

## SMOOTH

6 cm travel length of soft close  
stroke.  
Extremely silent and effortless  
drawer movement with exclusive  
dry-damper technology.



## NEW CHOICE

A5K Under Mount Can Work with  
wooden drawer or Repon's slim  
drawer, V-Line or R-Cube.



## NJ - 35D65

### Soft Close (Dry-Damper)

REPON 6th Generation soft close features its extremely smooth movement, and revolutionary press-release disconnect device for quick and effortless drawer removal.



## NJ - 85A01

### Heavy Duty with Soft Close

Side mount, the loading is 130lbs (60kgs), and guaranteed cycle is 50,000 times.



## NJ - 78036

### Heavy Duty with Soft Close

Side mount, the loading is 150lbs (68gs), and guaranteed cycle is 50,000 times.





## NJ - 38D58

### Push to Open

Compact mechanism to sustain the largest loading without compromising the push to open performance.

Side mount, the loading is 100lbs (45Kgs), and guaranteed cycle is 50,000 times.



## NJ - 78A01

### Heavy Duty with Push to Open

Side mount push to open with exclusive push to open mechanism.

Side mount, the loading is 130lbs (60Kgs), and guaranteed cycle is 50,000 times.



## NJ-76J05

### Super Heavy Duty with Lock in & out

Side mount or flat mount, the loading is 400lbs(180Kgs), lock in and out mechanism incorporated, and guaranteed cycle is 50,000 cycles,

Available size is from 14" to 60" at 2" increment.



## NJ-76Q01

### Heavy Duty

Side mount heavy duty, the loading is 300lbs(140Kgs).

Available size is from 300mm to 120mm at 50mm increment.





## NJ - 31J32

Side mount, the loading is 100lbs (45Kgs), and guaranteed cycle is 50,000 times.



## NJ - 76008

### Heavy Duty

Side mount heavy duty, the loading is 200lbs(90kgs), and guaranteed cycle is 50,000 times.

Available size is from 300mm to 1200mm at 50mm increment.



## NJ - 81A02

### Heavy Duty

Side mount, the loading is 150lbs (68Kgs), and guaranteed cycle is 50,000 times.



## NJ - 76J01

### Super Heavy Duty

Side mount or flat mount, the loading is 400lbs (180Kgs), and guaranteed cycle is 50,000 cycles.

Available size is from 10" to 72" increment.





*[www.repon.com.tw](http://www.repon.com.tw)*